



Installer's Guide

IMPORTANT INFORMATION

Read This Document First

On completion, sign and leave with owner

sunpro[®]

(Gas Post-Boost) Solar Water Heater Heat Exchange Kit Installer's Guide

To be used in conjunction with:

- **Sunpro Gas Post-Boost Solar Installer's Guide (P/N H4110)**
- **Sunpro Gas Post-Boost Solar Owner's Manual (P/N H1883)**

Installation by a licensed tradesperson and in accordance with:

- AS/NZS 3500.4 "National Plumbing & Drainage Code Hot Water Supply Systems – Acceptable Solutions"
- AS5601/AG601 Gas Installation
- Adherence to local authority and OH&S regulations
- Victorian PIC Requirements

For advice, repairs and service, call:

1300 365 115 (Australia)

0800 729 389 (New Zealand)

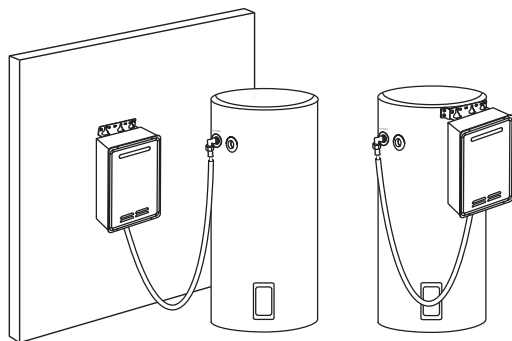

Specifications and materials may change without notice

Effective for Sunpro Gas Post-Boosted Solar Water Heaters manufactured and sold after 1st June 2010.



Installer's Guide

Parts List

Part No.	Quantity	UOM	Description
H0125	12	EA	Screw – #8 × 12 (#2 Point) ACR/PHIL/S
H3566	1	EA	Valve – Mix Solar ½" (MIX11116)
H3066	1	EA	Hose Lagged Tank to 20LPM Instantaneous
H1768	2	EA	Tank Bracket Gas Boosted Solar Kit
H1864	2	EA	Saddle – 32mm powder coated
H1861	1	EA	Nipple – Reducer ¾" × 1/2" Brass
H0140	1	EA	Bush – Reducer ¾" × 1/2" Brass
H1655	1	EA	Sunpro Gas Boosted Solar – Heat Exchange Kit Installer's Guide

Step 1

Important: The tank should be set up as per the *Sunpro Gas Boosted Solar Installer's Guide* (Part Number H4110) **before** the following steps are done.

Step 2

- Attach the reducing nipple (part number H1861) to the top left outlet socket.

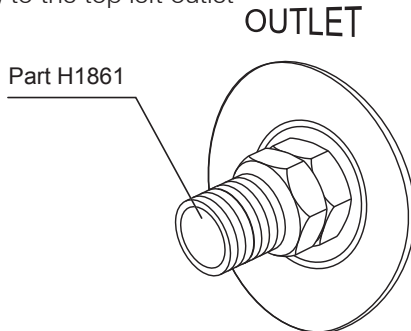



Installer's Guide

Step 3

- The Endurance unit can be either tank mounted or wall mounted.

Tank Mounting

- Attach one bracket (part number H1768) to the bottom of the Endurance unit using two of the screws provided.

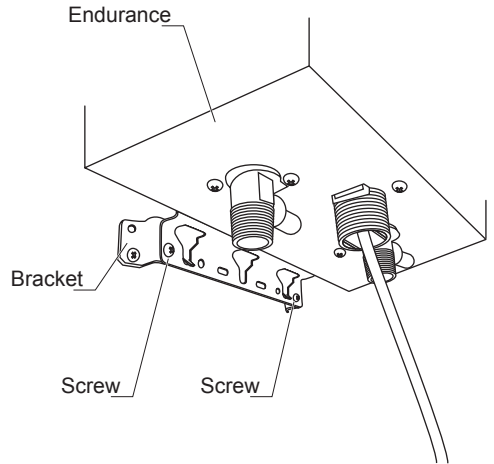
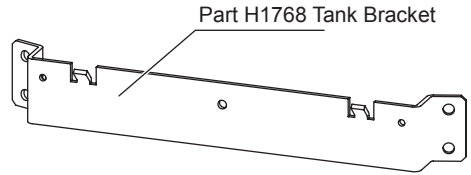

- Mount the upper bracket to the tank with a horizontal position midway between the outlets and a vertical position against the edge of the tank lid. Use 4 screws provided.

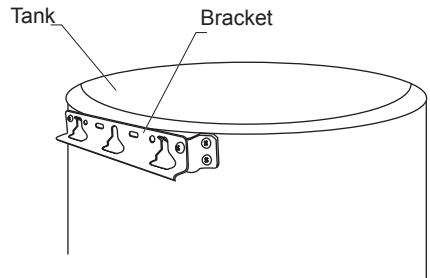



Installer's Guide

- Hang the Endurance unit onto the upper bracket and secure it to the bracket with two screws provided.
- Secure the lower bracket to the tank with a screw in each of the lower outer tank mounting holes.
- If required, fit the $\frac{3}{4}$ " \times $\frac{1}{2}$ " reducing bush (part number H0140) to the water inlet of the Endurance Unit.
- Connect the insulated water supply hose (part number H3066) between the top left tank outlet with the elbow end of the hose and the Endurance unit water inlet fitting with the straight connection.

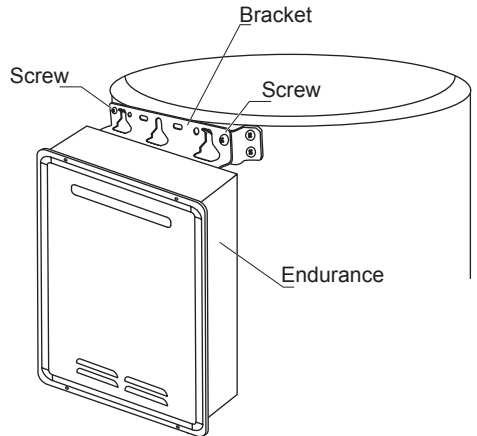

Note: Two GPOs are needed for this assembly – one for the Endurance and one for the pump/controller.

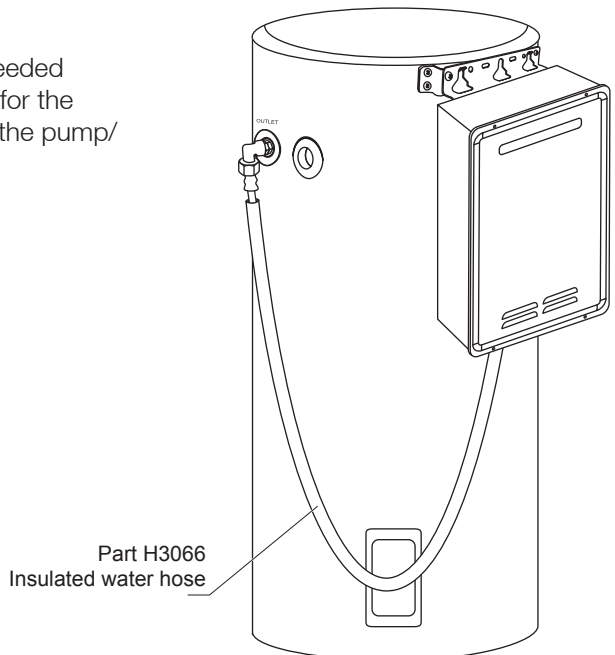



Installer's Guide

Wall Mounting

- For wall mounting, the brackets (H1768) are not used.
- Attach the Endurance unit to a suitable location using its own mounting brackets. Use appropriate fasteners (not supplied with kit).
- Use the insulated water hose (H3066) as supplied with the kit to connect the Endurance unit to the tank.



Note: Two GPOs are needed for this assembly – one for the Endurance and one for the pump/controller.

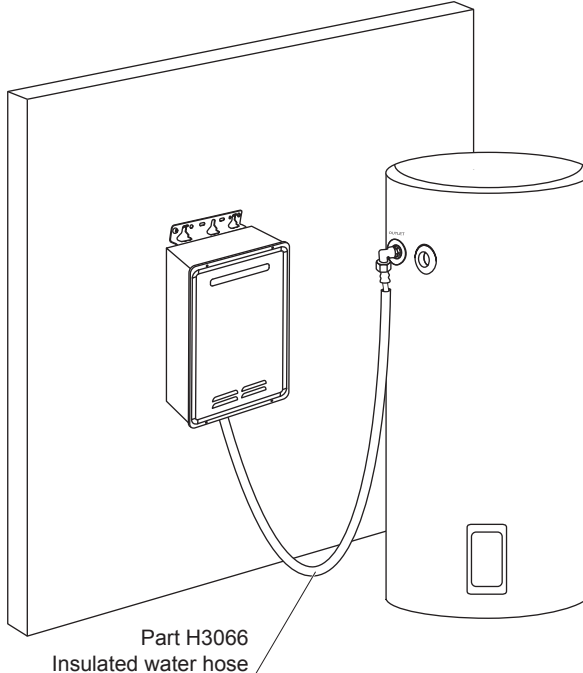



Installer's Guide

Step 4

Connecting the Collector Sensor to the Controller

Warning: Make sure the unit is NOT plugged to a power outlet during this step.



Warning

- Remove cover of the Resol controller.
- The figure 8 collector sensor cable (H3365) from the collector sensor supplied in the Collector Panel Rail Kit (PK5010) is connected to the Resol Controller terminal S1 ports 1 and 2. Polarity is not an issue.
- Replace cover of the Resol controller.

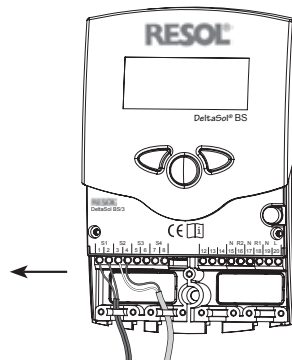
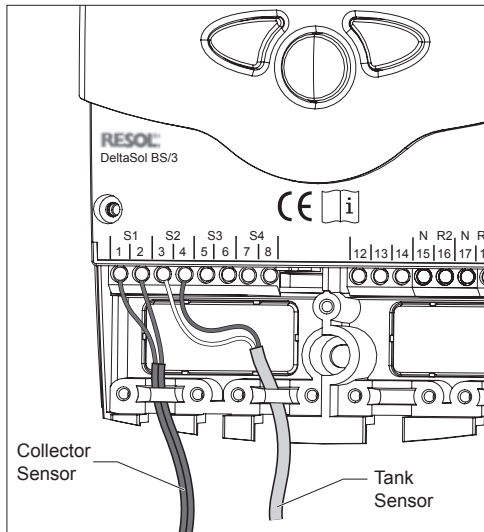



Sunpro GBS Heat Exchange Kit Installer's Guide

Installer's Guide

Step 5

- Continue with the rest of the installation procedure as per the *Sunpro Gas Boosted Solar Installer's Guide* (Part Number H4110).





Sunpro GBS Heat Exchange Kit Installer's Guide

sunpro[®]

**(Gas Post-Boost) Solar Water Heater
Heat Exchange Kit Installer's Guide**

For Advice, Repairs And Service, Call:

1300 365 115 (Australia)

0800 729 389 (New Zealand)